

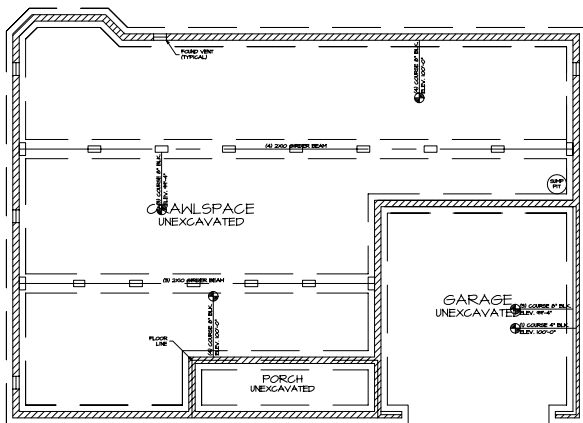

1 FRONT ELEVATION
A-1 SCALE: 1/4"=1'-0"



1 FOUNDATION PLAN
A-2 SCALE: 1/4"=1'-0"

- FOUNDATION PLAN NOTES:**
1. ALL FOUNDATIONS ARE TO BE CONCRETE FULL WALL.
 2. ALL FOUNDATIONS SHALL BE 12" MIN. THICK.
 3. ALL FOUNDATIONS SHALL BE 4" MIN. CONC. CONTAIN.
 4. ALL FOUNDATIONS SHALL BE 4" MIN. CONC. CONTAIN.
 5. ALL FOUNDATIONS SHALL BE 4" MIN. CONC. CONTAIN.
 6. ALL FOUNDATIONS SHALL BE 4" MIN. CONC. CONTAIN.
 7. ALL FOUNDATIONS SHALL BE 4" MIN. CONC. CONTAIN.
 8. ALL FOUNDATIONS SHALL BE 4" MIN. CONC. CONTAIN.
 9. ALL FOUNDATIONS SHALL BE 4" MIN. CONC. CONTAIN.
 10. ALL FOUNDATIONS SHALL BE 4" MIN. CONC. CONTAIN.

STATISTICS:		EXISTING:	PROPOSED:
AREA:		N/A	1,807 S.F.
FIRST FLOOR AREA:		N/A	N/A
SECOND FLOOR AREA:		N/A	1,807 S.F.
TOTAL LIVING AREA:		N/A	N/A
BASEMENT AREA:		N/A	457 S.F.
GARAGE AREA:		N/A	2,264 S.F.
TOTAL AREA:		N/A	

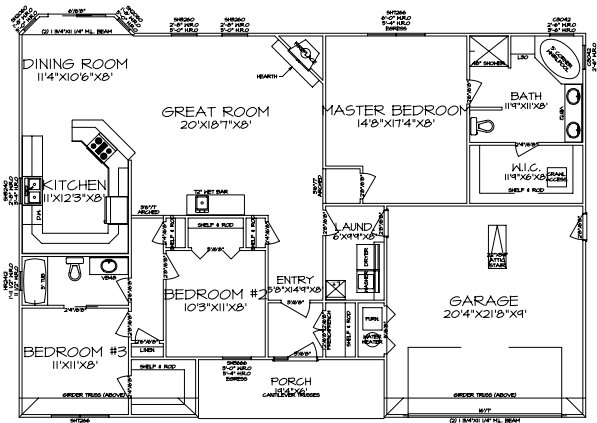

1 FIRST FLOOR PLAN
A-3 SCALE: 1/4"=1'-0"

- FLOOR PLAN NOTES:**
1. ALL WALLS ARE TO BE 1/2" MIN. THICK.
 2. ALL WALLS ARE TO BE 1/2" MIN. THICK.
 3. ALL WALLS ARE TO BE 1/2" MIN. THICK.
 4. ALL WALLS ARE TO BE 1/2" MIN. THICK.
 5. ALL WALLS ARE TO BE 1/2" MIN. THICK.
 6. ALL WALLS ARE TO BE 1/2" MIN. THICK.
 7. ALL WALLS ARE TO BE 1/2" MIN. THICK.
 8. ALL WALLS ARE TO BE 1/2" MIN. THICK.
 9. ALL WALLS ARE TO BE 1/2" MIN. THICK.
 10. ALL WALLS ARE TO BE 1/2" MIN. THICK.

GALLIVAN'S
DRAFTING & DESIGN
(217) 202-5998